



FOR BOOKING INQUIRY CONTACT ON : **+91 7600001144 / +91 7600001188**



STRUCTURAL ENGINEER  
**SHREEJI STRUCRURALS**  
KETAV JOSHI



Site Address :  
**SARAL DREAMZ**  
Nr. Girivar Galaxy Bungalows,  
Opp. Reliance Petrol Pump,  
S. P. Ring Road, Vastral,  
Ahmedabad - 382418

design and production @ oxygen inc. +91 98257 09244



COLOURFULL LIFE BEHIND WHITE WALLS



The SARAL Group is founded on the thought of inspiring a better tomorrow by providing people with improved life and living standards at affordable prices.

We endeavour to commit ourselves to provide our customers with the finest design, aesthetics and values that match international standards.

At SARAL DREAMZ, we believe in a futuristic approach to strengthen this commitment to excellence. With this as our founding philosophy, we are striding towards establishing a leadership position for ourselves in the industry and satisfying our customers by providing much more than what they anticipate.

Parallelly, we are also committed towards our motto of designing residential and commercial complexes of a progressive Ahmedabad yet adhering to our values, which positively transforms the world and makes it a better place to live in...



# SARAL DreamZ

2 AND 3 BHK ULTRA SPACIOUS FLATS

**First time in VASTRAL...**  
A contemporary building  
with **super-spacious residences** per floor.



**PRIDE** OF POSSESSION, **PEACE** OF MIND AND THE **PLEASURE** OF LIVING.



  
**SARAL  
DreamZ**  
2 AND 3 BHK ULTRA SPACIOUS FLATS

Welcome to SARAL DREAMZ. Conveniently located in Ahmedabad. SARAL DREAMZ is an exclusive gated and secure planned development in Ahmedabad, where all the residents' needs are within easy walking distance.

Created from barren land, this luxuriantly green and grand Scheme is a tangible expression of a vision to create better communities. Blending the essentials of peace, calm and comfort with luxury of opulence, space and style, this unique creation is truly in tune with the nature.



REFLECTION OF THE MOST COMFORTING LIFESTYLE.



ULTRA CONTEMPORARY AESTHETIC BUILDING ELEVATION.



SPACIOUS LAYOUT FOR COMFORTABLE LIVING.



DECORATIVE ENTRANCE GATE WITH SECURITY CABIN.



BASEMENT AND GROUND LEVEL PARKING FACILITY



FULLY AUTOMATIC 2 LIFTS IN EACH BLOCK



BEAUTIFULLY LANDSCAPED GARDEN



CHILDREN PLAY AREA AND SENIOR CITIZEN SITOUTS



PICKUP AND DROP OFF ZONE FOR CHILDREN



R.C.C. ROADS WITH STREET LIGHTS.



BORE WELL FOR 24 HOURS WATER SUPPLY.



Pride at your SARAL DREAMZ - your family's prized possession, where your young ones grow up in the lap of nature and comfort; and you pride at having made the right choice at the right time.

Because each day of your lives becomes your memory. And your family's memories deserve to be nothing less than the best.

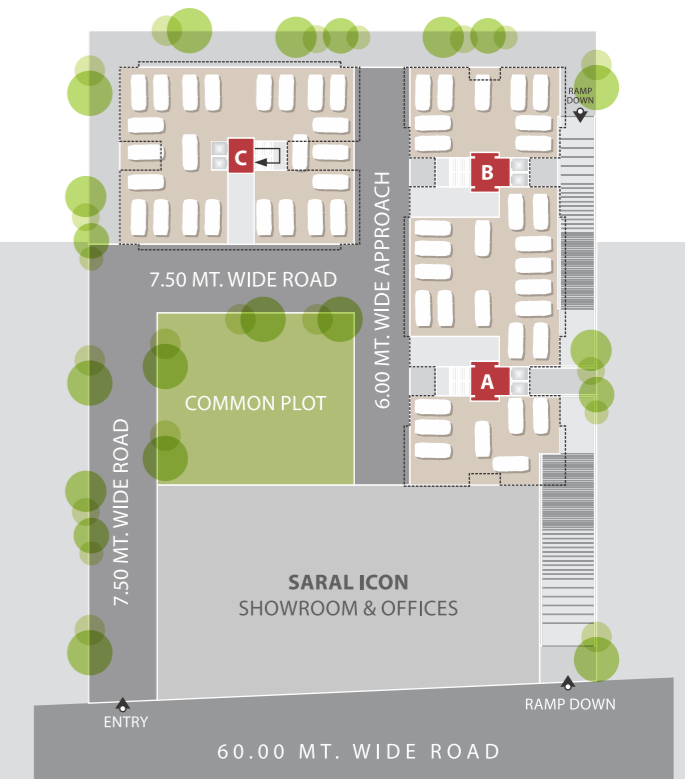

PARKING FACILITY ON **GROUND FLOOR**





**3 BHK**  
UNIT PLAN  
TYPE 1

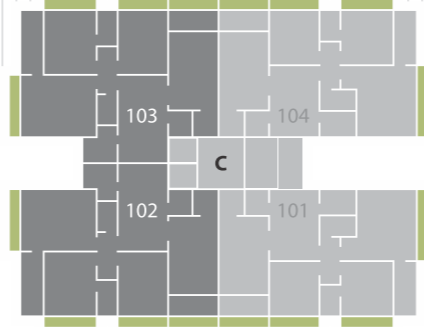

**3 BHK**  
UNIT PLAN  
TYPE 2

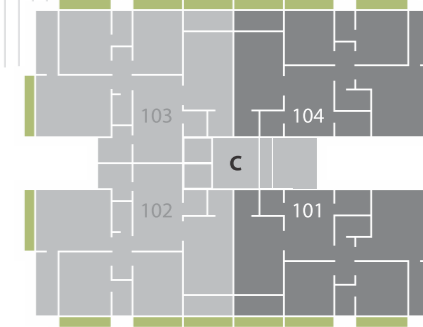



MODERN DESIGN CONCEPTS THAT COMPLEMENT YOUR SENSIBILITIES.



  
**SARAL  
Dreamz**  
2 AND 3 BHK ULTRA SPACIOUS FLATS

SARAL DREAMZ is grandest scheme that exudes endless charm, elegance and unmatched class. In the heart of the city this magnificent scheme shall have a whole new experience of convenience and class merging seamlessly to make your home the perfect one.



BLENDING THE ESSENTIALS OF **PEACE**, **CALM** AND **COMFORT**.



### SPECIFICATION

- |                    |  |
|--------------------|--|
| Structure          | • Earth-Quake Resistance RCC Frame structure with brickwall.   |
| Plaster            | • Internal Single coat mala plaster with base putty finish and external double coat plaster with fully acrylic paint.  |
| Flooring           | • Vitrified tiles flooring in living, dining, kitchen, bedrooms and all other areas. Terrace finished with china mosaic.   |
| Doors / Windows    | • Decorative main entrance door with wooden frame & all other doors will be wooden framed flush door shutters with lock.<br><br>• All windows will be made of powder coated aluminum sections. |
| Kitchen            | • Mirror polished granite platform with glazed tiles dedo up to lintel level and S. S. Sink.   |
| Bath room / Toilet | • Designer superior quality glazed tiles flooring and dedo up to lintel level.   |
| Plumbing           | • Concealed center point plumbing adequate points with standard fittings   |
| Electrification    | • Three phase concealed copper wiring with good quality accessories with sufficient electric points.   |
| Water              | • 24 hour water supply by common bore well to over head water tank by pressure pump.   |

**PLEASE NOTE**

• All rights are reserved by the developers to make any changes in the plan, elevation, specification and future additional development in surrounding area in the scheme and shall be binding to all the members. • All Government legal charges, Stamp registration charges, common maintenance charges and service tax shall be borne extra by the members. • In case of irregular payments interest / new book value will be charged. • Cancellation charge would be decided by the developers. • No external changes shall be allowed. Only internal changes will be allowed with prior permission and shall be charged extra in advance. • Dimensions and area mentioned in the brochure are approximate and indicative. • This brochure is not a part of legal documents. • Possession will be given after 30 days of completion of payment. • If there is some change in the planning and design that should be accepted by members. • Unit will not be sold by member before the possession.